

BELMONT / WATERTOWN  
TRAPELO RD & BELMONT ST

STATE	FED PROJ. AID NO.	SHEET NO.	TOTAL SHEETS
MASS	CMS1P-0028(110)	124	240
PROJ. F.E. NO. 804688			

PAVEMENT MARKING & SIGNING PLAN

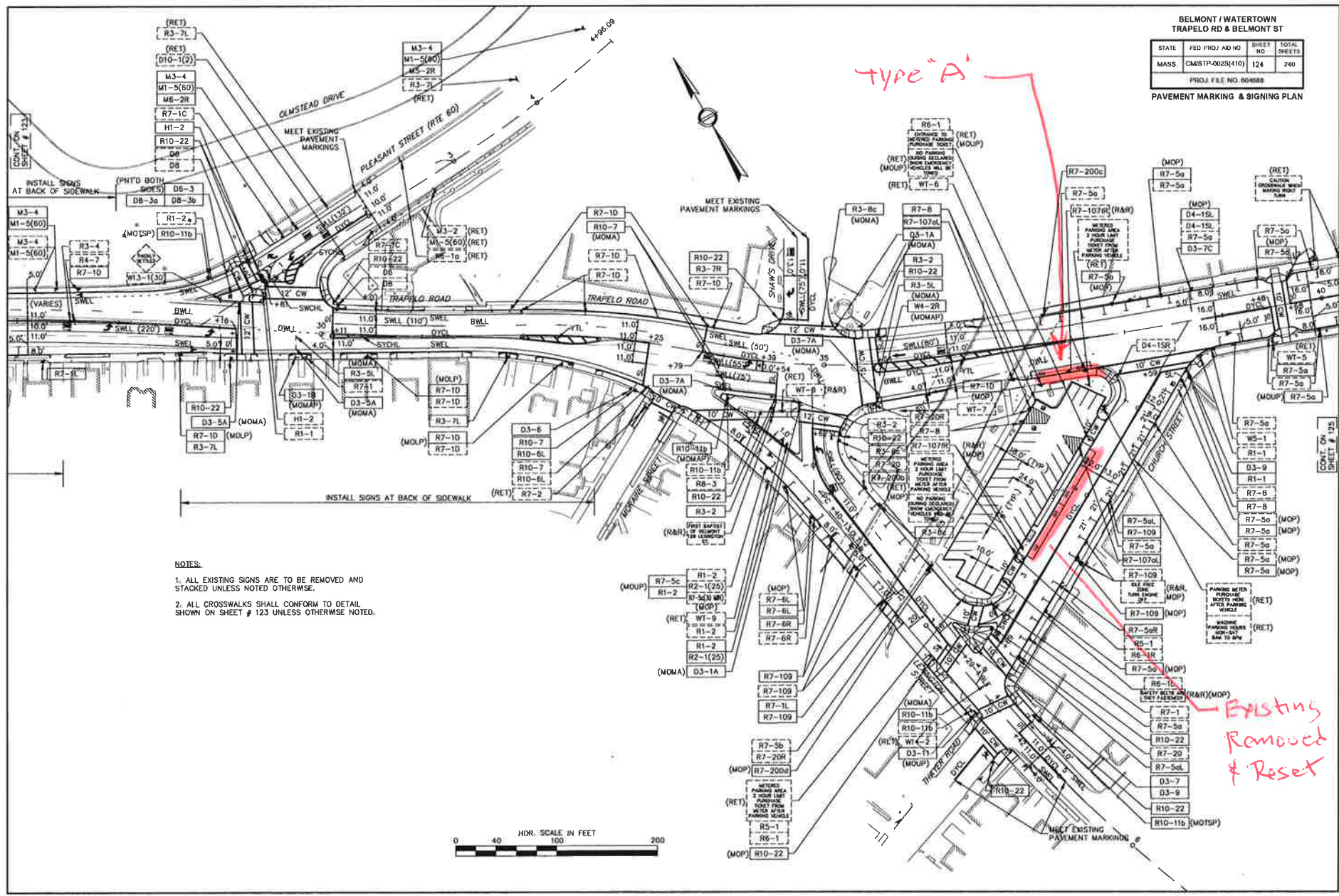

NOTES:

1. ALL EXISTING SIGNS ARE TO BE REMOVED AND STACKED UNLESS NOTED OTHERWISE.
2. ALL CROSSWALKS SHALL CONFORM TO DETAIL SHOWN ON SHEET # 123 UNLESS OTHERWISE NOTED.



Existing  
Removed  
& Reset

**BELMONT / WATERTOWN  
TRAPELO RD & BELMONT ST**

STATE	FED. PROJ. NO.	SHEET NO.	TOTAL SHEETS
MASS.	CMSTP-0028(410)	125	240
PROJ. FILE NO. 604668			

**PAVEMENT MARKING & SIGNING PLAN**

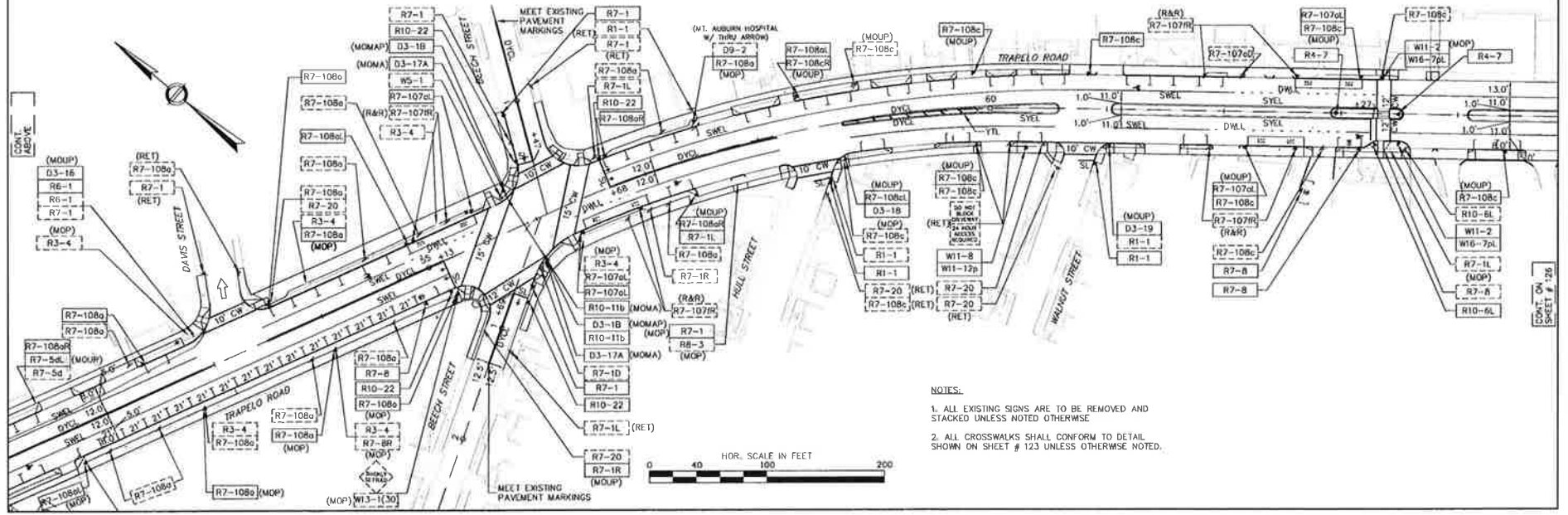
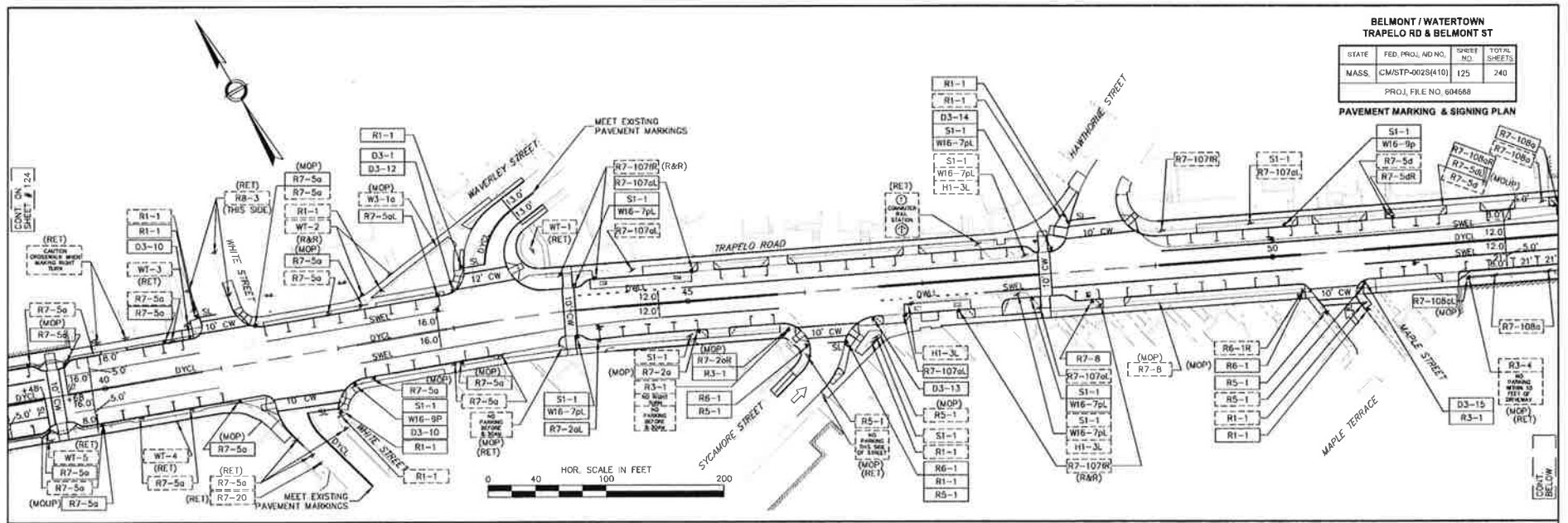

- NOTES:**
1. ALL EXISTING SIGNS ARE TO BE REMOVED AND STACKED UNLESS NOTED OTHERWISE.
  2. ALL CROSSWALKS SHALL CONFORM TO DETAIL SHOWN ON SHEET # 123 UNLESS OTHERWISE NOTED.

CONT. BELOW

CONT. ON SHEET # 126



**BELMONT / WATERTOWN  
TRAPELO RD & BELMONT ST**

STATE	FED. PROJ. NO.	SHEET NO.	TOTAL SHEETS
MASS.	CM/STP-002S(410)	127	240
PROJ. FILE NO. 604688			

**PAVEMENT MARKING & SIGNING PLAN**

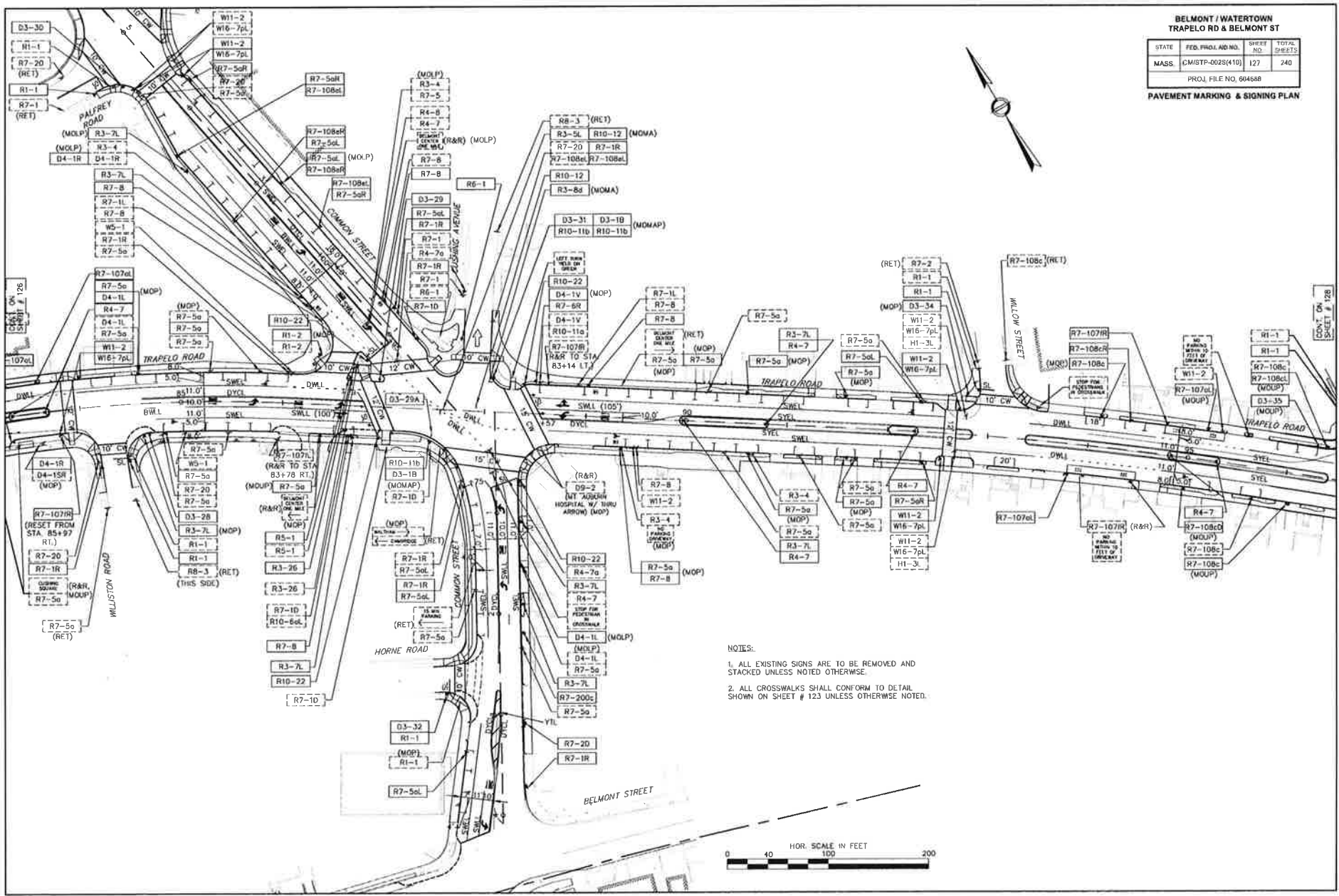

- NOTES:
1. ALL EXISTING SIGNS ARE TO BE REMOVED AND STACKED UNLESS NOTED OTHERWISE.
  2. ALL CROSSWALKS SHALL CONFORM TO DETAIL SHOWN ON SHEET # 123 UNLESS OTHERWISE NOTED.

BELMONT / WATERTOWN  
TRAPELO RD & BELMONT ST

STATE	FED PROJ. #	PROJ. #	SHEET NO.	TOTAL SHEETS
MASS	CMS/TP-002S(10)		128	240
PROJ. FILE NO. 604566				

PAVEMENT MARKING & SIGNING PLAN

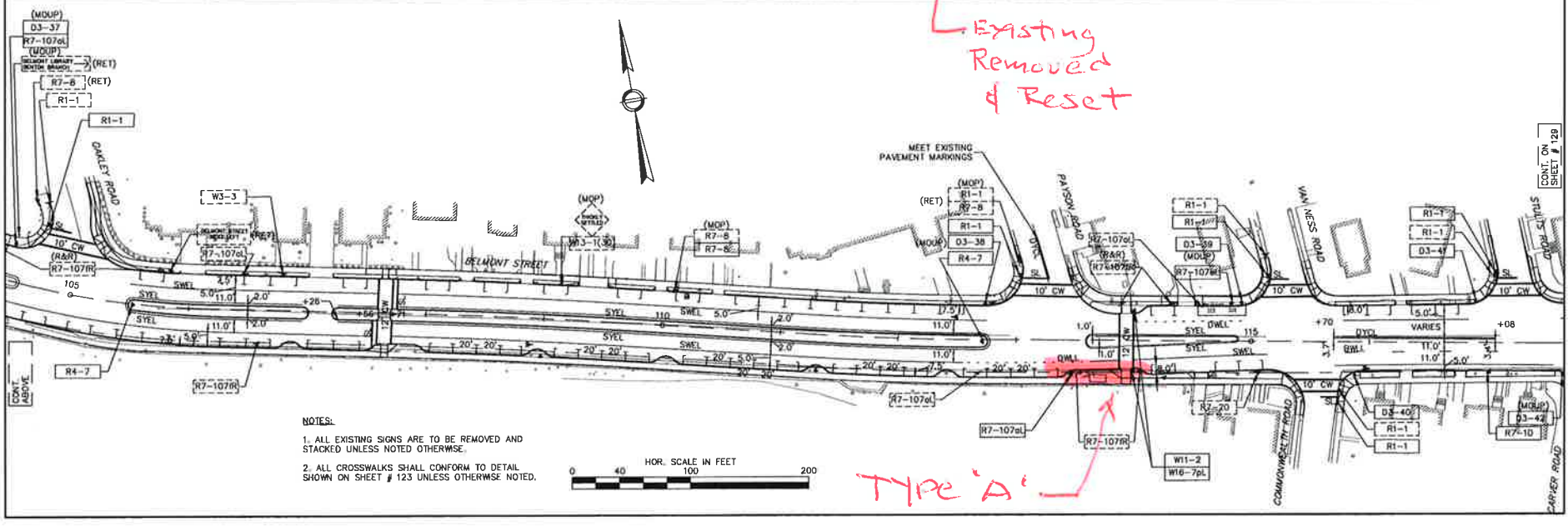
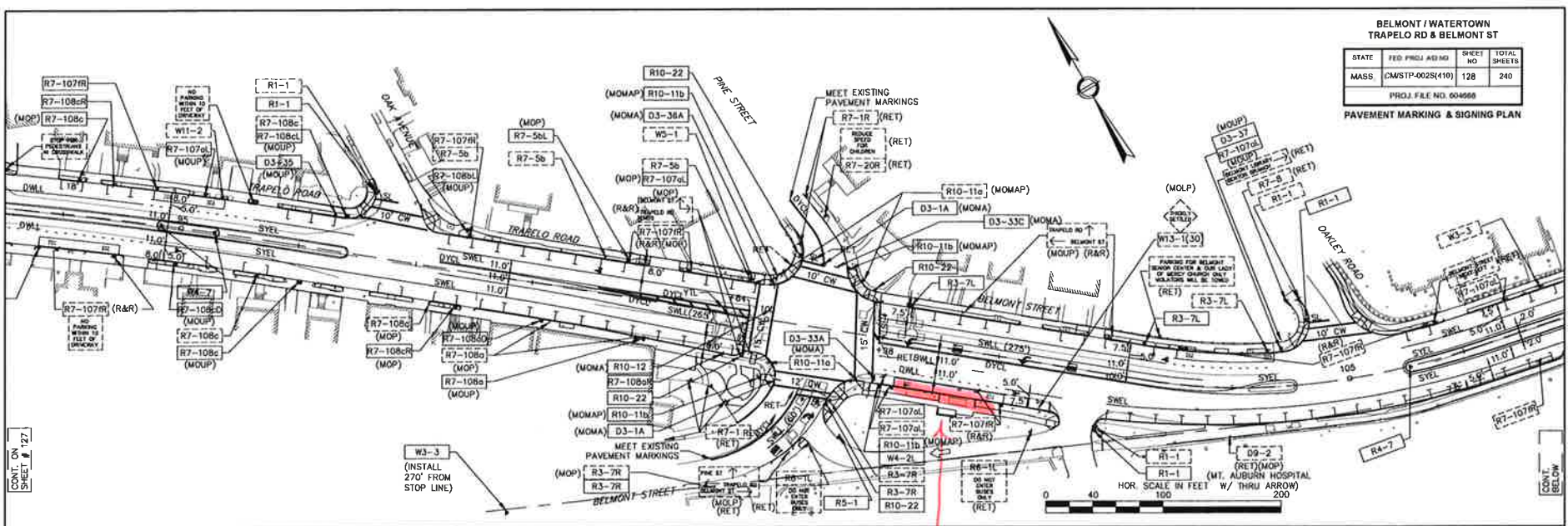

- NOTES:
1. ALL EXISTING SIGNS ARE TO BE REMOVED AND STACKED UNLESS NOTED OTHERWISE.
  2. ALL CROSSWALKS SHALL CONFORM TO DETAIL SHOWN ON SHEET # 123 UNLESS OTHERWISE NOTED.

Existing  
Removed  
& Reset

TYPE 'A'

CONT. ON SHEET # 127

CONT. BELOW

CONT. ABOVE

CONT. ON SHEET # 128

**BELMONT / WATERTOWN  
TRAPELO RD & BELMONT ST**

STATE	FED. PROJ. NO.	SHEET NO.	TOTAL SHEETS
MASS.	CM/STP-0028(410)	129	240
PROJ. FILE NO. 604688			

**PAVEMENT MARKING & SIGNING PLAN**

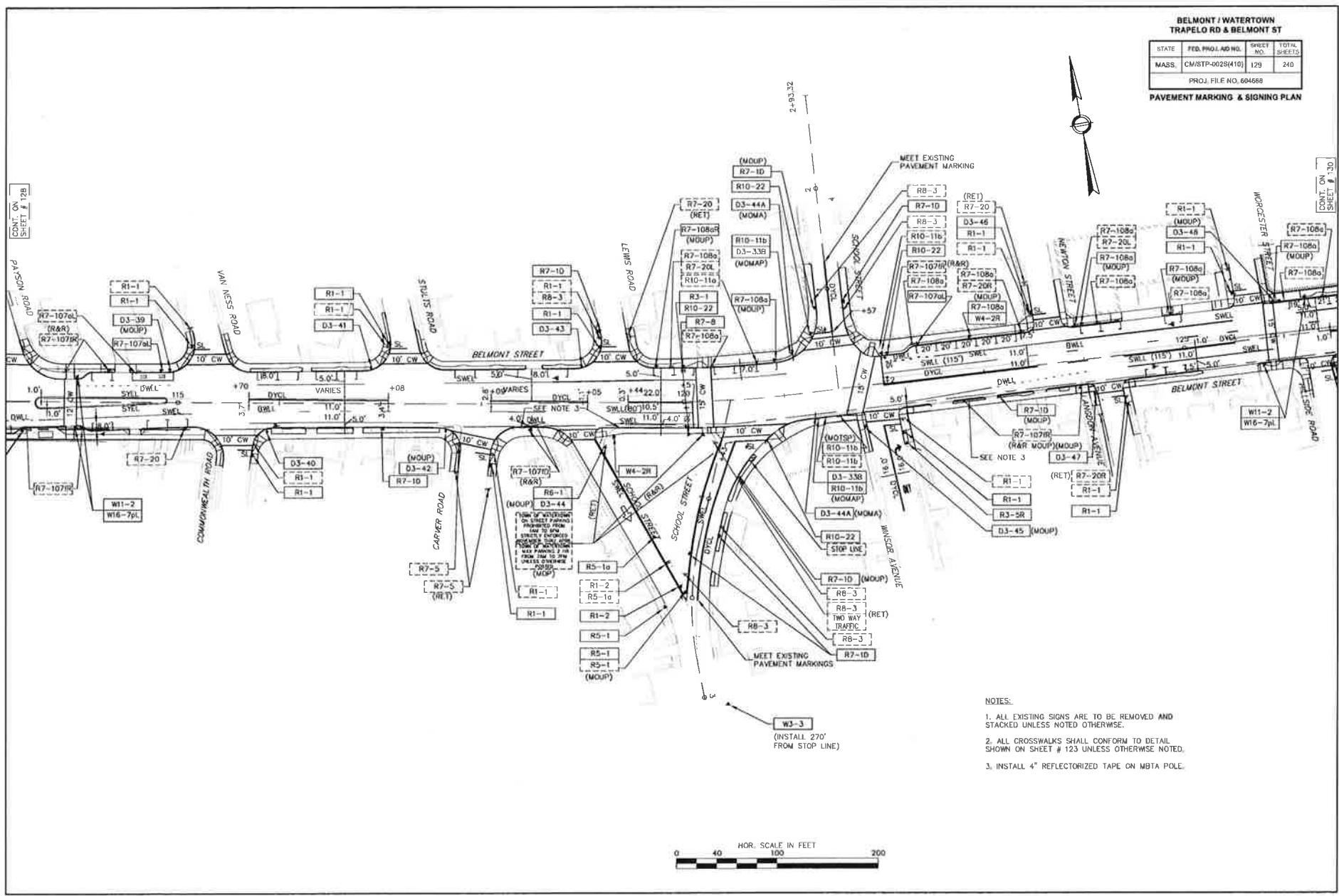

- NOTES:**
1. ALL EXISTING SIGNS ARE TO BE REMOVED AND STACKED UNLESS NOTED OTHERWISE.
  2. ALL CROSSWALKS SHALL CONFORM TO DETAIL SHOWN ON SHEET # 123 UNLESS OTHERWISE NOTED.
  3. INSTALL 4" REFLECTORIZED TAPE ON MBTA POLE.



CONT. ON SHEET # 128

CONT. ON SHEET # 130

BELMONT / WATERTOWN  
TRAFALD RD & BELMONT ST

STATE	FED PROJ ADO NO	SHEET NO	TOTAL SHEETS
MASS	CMSTP-0028(410)	130	240
PROJ FILE NO 004688			

PAVEMENT MARKING & SIGNING PLAN

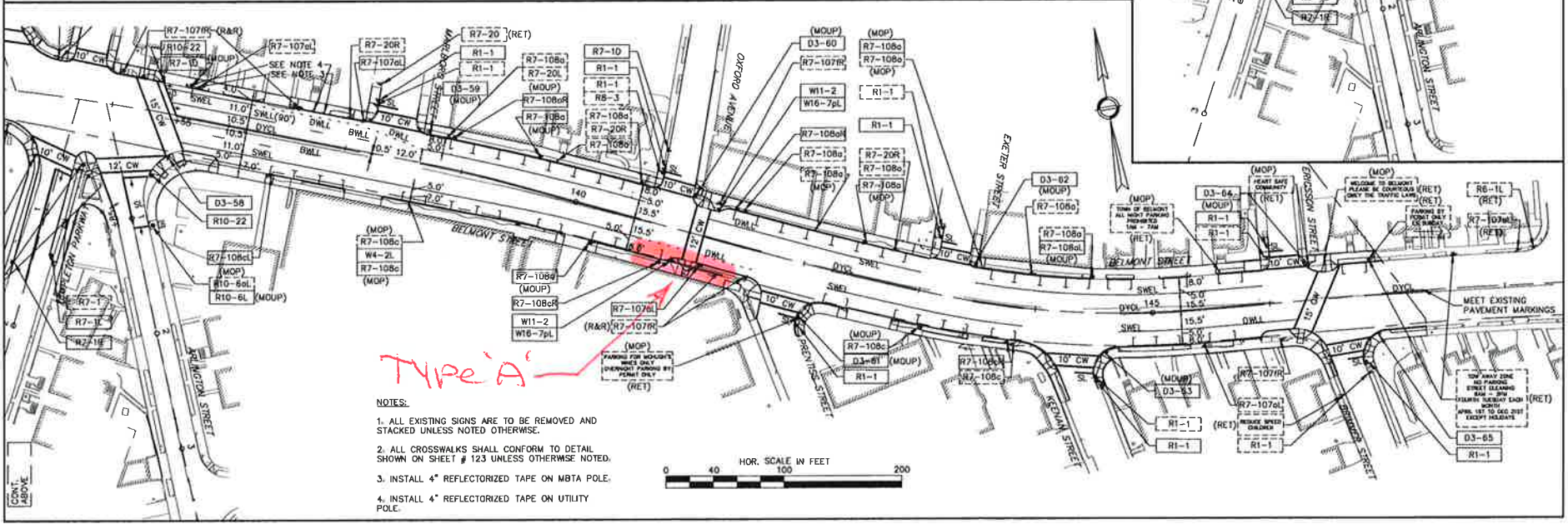
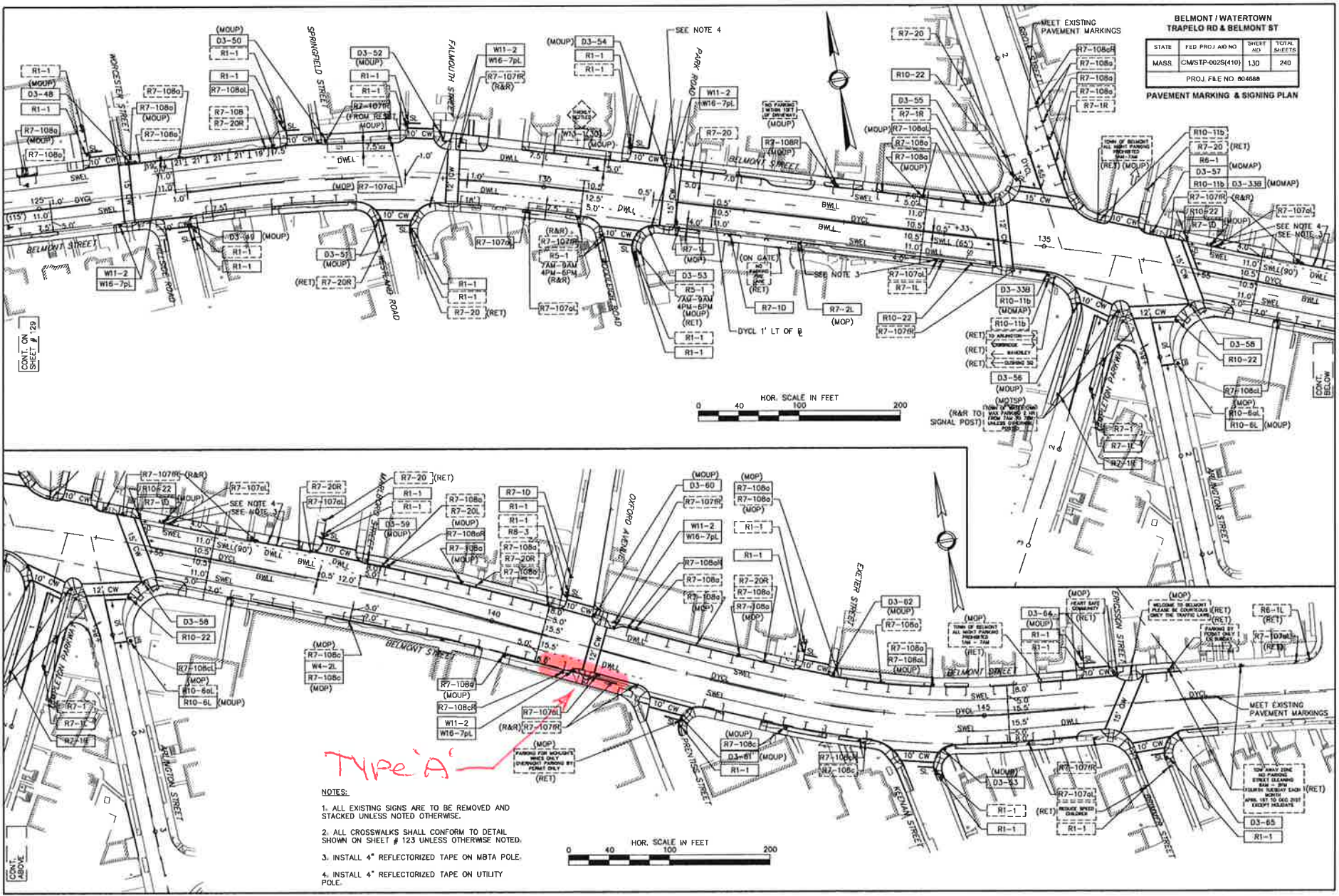

- TYPE 'A'**
- NOTES:
1. ALL EXISTING SIGNS ARE TO BE REMOVED AND STACKED UNLESS NOTED OTHERWISE.
  2. ALL CROSSWALKS SHALL CONFORM TO DETAIL SHOWN ON SHEET # 123 UNLESS OTHERWISE NOTED.
  3. INSTALL 4" REFLECTORIZED TAPE ON MBTA POLE.
  4. INSTALL 4" REFLECTORIZED TAPE ON UTILITY POLE.